

Site & Building Concepts

SOUTH CAROLINA AERONAUTICAL TRAINING CENTER





CONTENTS

I. VISIONING

& Steering Committee Workshops

II. MAIN CAMPUS

& Expanded Campus Vision

III. AERONAUTICAL TRAINING CENTER

& Proposed Main Site Plan

IV. PROGRAMMING

& Allocation of Spaces and Uses

V. BUILDING LAYOUT

& Proposed Floor Plans

VI. LEED CHECKLIST

& Low Impact Development Case Studies

ACKNOWLEDGEMENTS



SITE & CONCEPT DESIGN STEERING COMMITTEE

Trident Technical College, Administration

Mary Thornley

Meg Howle

Scott Poelker

Eric Hamilton

Trident Technical College, Aeronautical Studies

Barry Franco

Lonnie Burbage

Rudy Salcedo

Tom Kamenicky

Trident Technical College, Continuing Education & Economic Development

Bob Walker

Stanley Johnson

Trident Technical College Staff & Other

Larry Savidge

Tammy Gunter

MG Mitchum

Rodney Maxwell

Chris Lang

readySC

Jim Maxon

Terrance Rivers

Howard White

Sean Gentry

DESIGN TEAM

O'Brien & Gere, Project Management

Bryan Wood, P.E.

Lindbergh & Associates, Site Team

Richard Garcia, P.E.

Forest McKenzie, P.E., P.L.S.

Brendon Wilson, P.E.

Ray Nix, EIT

Keane McLaughlin, ASLA

Charles Harbin, P.E.

Juan Avila, P.E.

Kayce McCall, P.E.

Lindbergh & Associates, Building Team

Dennis Blaschke, AIA

Artemiy Zheltov, LEED AP

Janette Alexander, AIA

Liz Magalis, LEED AP

Ramey Kemp & Associates, Traffic Study

Stephen Greene, P.E.

WHY

*the MISSION of the
SOUTH CAROLINA AERONAUTICAL TRAINING CENTER
is to...*

INSPIRE
*a new generation of
students & leaders*

...through
Example

PREPARE
*a highly skilled
workforce*

...through
Synergy

LEAD
*and advocate for
our state*

...through
Stewardship

PROMOTE
best practices

...through
Collaboration

create a
**WORLD
CLASS**
environment



I. VISIONING

& Steering Committee Workshops







II. TRIDENT TECHNICAL COLLEGE MAIN CAMPUS

& Expanded Campus Vision



0 150 300 600

SCALE 1:300

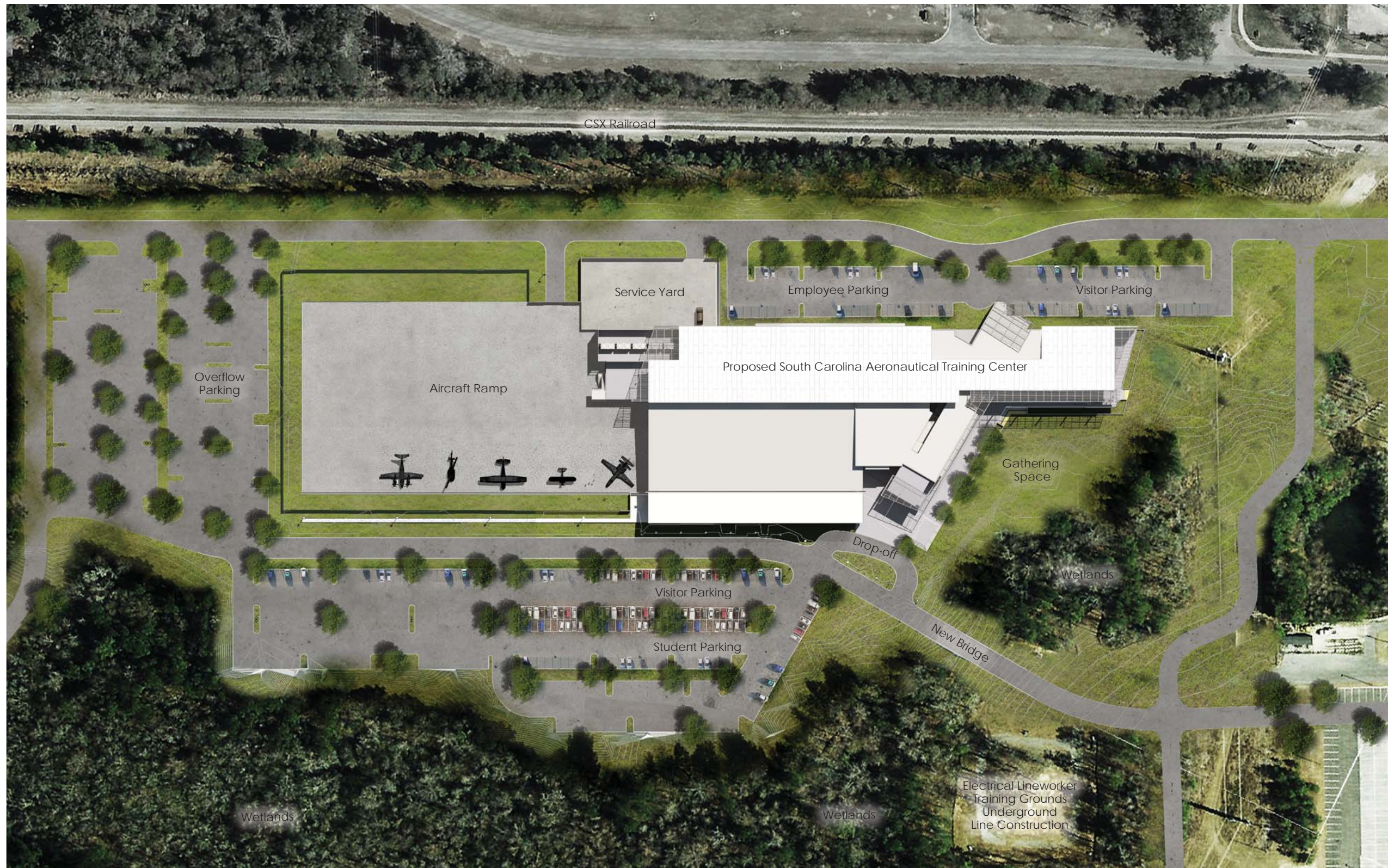



III. SOUTH CAROLINA
AERONAUTICAL TRAINING CENTER
Proposed Main Site Plan

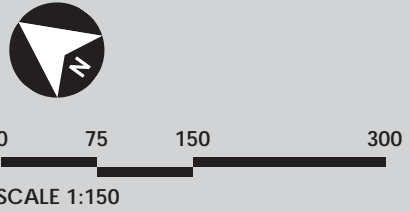

TOTAL GROSS¹
225,346 sf
100%

TOTAL NET
204,860 sf
90%

AERONAUTICAL STUDIES
88,664 sf
39%

WORKFORCE DEVELOPMENT
29,744 sf
13%

A
AERONAUTICAL STUDIES
88,664 sf

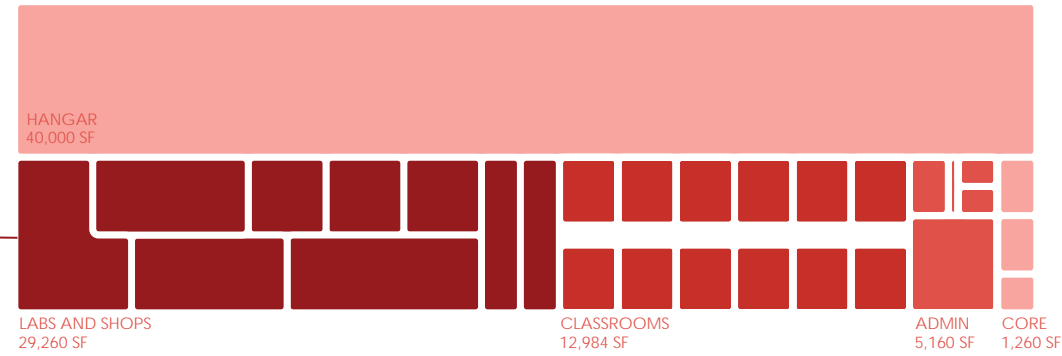

HANGAR
40,000 SF

LABS AND SHOPS
29,260 SF

CLASSROOMS
12,984 SF

ADMIN
5,160 SF

CORE
1,260 SF

W
WORKFORCE DEVELOPMENT
29,744 sf

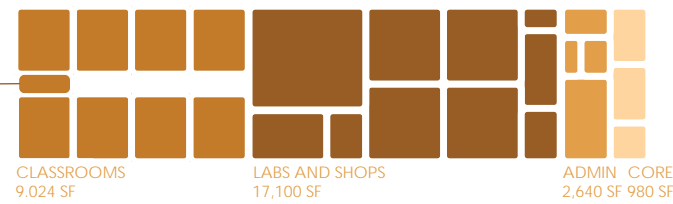

CLASSROOMS
9,024 SF

LABS AND SHOPS
17,100 SF

ADMIN
2,640 SF

CORE
980 SF

B
readySC TRAINING
40,592 sf

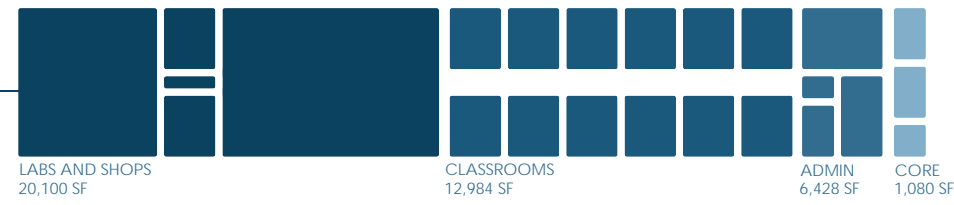

LABS AND SHOPS
20,100 SF

CLASSROOMS
12,984 SF

ADMIN
6,428 SF

CORE
1,080 SF

E
EDUCATIONAL ACTIVITIES
20,360 sf



GATHERING SPACES
17,000 SF

CORE
3,360 SF

C
CORE FUNCTIONS & SUPPORT
25,500 sf

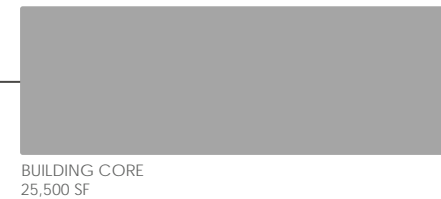

BUILDING CORE
25,500 SF

HANGAR	# SPACES	SF/SPACE	NET SF
Hangar	1	40,000	40,000
Hangar Catwalks	2	2,500	0
			40,000

LABS & SHOPS	# SPACES	SF/SPACE	NET SF
Airframe Lab (ACM)	1	4,000	4,000
Powerplant Lab (ACM)	1	2,400	2,400
Avionics Lab (AVT)	1	2,400	2,400
Avionics Bench Lab (AVT)	1	2,400	2,400
Composites Lab - Clean (AMF)	1	1,600	1,600
Composites Shop - Dirty (AMF)	1	1,600	1,600
Sealant Lab (ACM/AMF)	1	1,600	1,600
Aeronautical Basics & Hydraulic Lab (ACM/AMF/AVT)	1	1,600	1,600
Sheet Metal Shop (ACM/AMF/AVT)	1	1,600	1,600
Welding Shop (ACM)	1	1,200	1,200
Welding Shop (AMF & Con-Ed)	0	800	0
Paint Shop (ACM)	1	1,600	1,600
Tool Room	1	1,600	1,600
Aircraft Parts Storage Room	1	1,600	1,600
General Storage	1	800	800
HazMat Storage/Waste	4	200	800
Loading/Crane Area	1	800	800
Electrical Room	1	80	80
IT/Com Room	1	80	80
Men's Restroom	0	600	0
Women's Restroom	0	600	0
Corridors	1	1,500	1,500
			29,260

CLASSROOMS	# SPACES	SF/SPACE	NET SF
Master Academic Classroom	12	960	11,520
Collaboration Room	2	192	384
Corridors	1	1,080	1,080
			12,984

OFFICES	# SPACES	SF/SPACE	NET SF
Reception & Waiting	1	300	300
Office, Dean or Dept Head	3	160	480
Office, Professor	12	140	1,680
Office, Adjunct Shared	1	1,000	1,000
Student Advisement Lab	1	800	800
Admin Records	1	300	300
Conference Room	1	600	600
Mail/Copy Room	1	300	300
Mechanical Room	1	200	200
Electrical Room	1	80	80
IT/Com Room	1	80	80
Men's Restroom	0	800	0
Women's Restroom	0	800	0
Faculty/Unisex	1	60	60
FP Riser/ Janitor Room	1	60	60
Department Corridors	1	480	480
			6,420

AERONAUTICAL STUDIES Subtotal 88,664

LABS & SHOPS	# SPACES	SF/SPACE	NET SF
Future Lab: Tier 1 Partner	1	2,400	2,400
Mechatronics & Industrial Automation Lab	1	1,800	1,800
Quality/NDI Lab	1	1,200	1,200
Industrial Maintenance Lab	1	1,200	1,200
Composites Lab - Clean	1	1,600	1,600
Composites Shop - Dirty	1	800	800
Structures/Assembly Lab	1	1,800	1,800
Sealant Lab	1	1,600	1,600
Electrical Lab	1	1,200	1,200
Sheet Metal Shop	1	800	800
Welding Shop	0	800	0
Paint Shop	0	1,600	0
Trainee Breakroom	1	600	600
Tool Room	1	600	600
General Storage	2	500	1,000
HazMat Storage/Waste	1	200	200
Loading/Crane Area	1	300	300
			17,100

CLASSROOMS	# SPACES	SF/SPACE	NET SF
Master Academic Classroom	4	960	3,840
Subdividable Classroom	4	1,200	4,800
Collaboration Rooms	2	192	384
			9,024

OFFICES	# SPACES	SF/SPACE	NET SF
Reception & Waiting	1	300	300
Office, Director	1	180	180
Office, Professor	3	140	420
Office, Facility Resource Mgr	1	140	140
Office, Adjunct Shared	1	800	800
Conference Room	1	600	600
Mail/Copy Room	1	200	200
Mechanical Room	1	200	200
Electrical Room	1	80	80
IT/Com Room	1	80	80
Men's Restroom	0	800	0
Women's Restroom	0	800	0
Faculty/Unisex	1	60	60
FP Riser/ Janitor Room	1	80	80
Department Corridors	1	480	480
			3,620

TTC CON-ED Subtotal 29,744

¹ Total gross area includes 10% or 20,486 sf area factor for exterior and interior wall thickness and interstitial core spaces.

² Site Elements are not included in the building area

readySC TRAINING

40,592 sf

18%

LABS & SHOPS	# SPACES	SF/SPACE	NET SF
Composites Lab - Clean	1	1,000	1,000
Composites Shop - Dirty	1	2,000	2,000
Systems Electrical Lab	1	2,500	2,500
Bond & Ground Lab	1	2,000	2,000
Structures Lab	1	4,200	4,200
Sealant Lab	1	1,600	1,600
Instructors Open Office	1	1,000	1,000
Trainee Breakroom	1	600	600
Tool Issue & Storage	1	1,600	1,600
Repair Shop	1	400	400
Prep/Materials Storage	2	300	600
General Storage	2	1,000	2,000
HazMat Storage/Waste	1	300	300
Loading/Crane Area	1	300	300
			20,100
CLASSROOMS			
Master Academic Classroom	2	960	1,920
Subdividable Classroom	10	960	9,600
Collaboration Room	2	192	384
Corridors	1	1,080	1,080
			12,984
OFFICES			
Reception & Waiting	1	1,200	1,200
Office, Director	2	192	384
Office, Managers (Shared)	4	192	768
Office, Staff	4	144	576
Admin Area	1	600	600
Admin RIM Storage	1	300	300
Admin Ready-Use Storage	1	200	200
Staff Open Office	1	1,000	1,000
Conference/Team Room	1	600	600
Mail/Copy/Plot Room	1	200	200
Staff Breakroom	1	600	600
Mechanical Room	1	200	200
Electrical Room	1	80	80
IT/Boeing Switch Room	1	120	120
IT/Com Room	1	80	80
Men's Restroom	0	800	0
Women's Restroom	0	800	0
Faculty/Unisex	1	60	60
FP Riser/ Janitor Room	1	60	60
Department Corridors	1	480	480
			7,508
BOEING TRAINING Subtotal			40,592

EDUCATIONAL ACTIVITIES

20,360 sf

9%

GATHERING SPACES	# SPACES	SF/SPACE	NET SF
Visitor Entry Lobby	0	800	0
Lecture Hall	0	600	0
Lecture (Exhibit/Conference/Flex)	2	3,000	6,000
Lecture (Future Exhibit/Lab/Flex Shell)	1	6,000	6,000
Chair & Table Storage	2	600	1,200
Café	1	400	400
Café Lounge / Vending	1	2,400	2,400
Aeronautical Museum & Library	1	1,000	1,000
Men's Restroom	1	1,200	1,200
Women's Restroom	1	1,200	1,200
Department Corridors	2	480	960
ENTERPRISE & CONFERCING Subtotal			20,360

CORE FUNCTIONS

25,500 sf

11%

CORE	# SPACES	SF/SPACE	NET SF
Student Entry Lobby	0	900	0
Faculty/Visitor Entry Lobby	0	900	0
Concourse A	1	9,600	9,600
Concourse B	1	5,600	5,600
Communicating Stair	0	320	0
Stairwells	3	240	720
Public Elevator	3	80	240
Freight Elevator	3	140	420
Elevator Equipment Room	2	80	160
Main FP Riser/Pump Room	1	100	100
Main Mechanical Room	0	1,600	0
Mechanical Mezzanine	1	3,200	3,200
Main IT/Com Room	1	200	200
General Building Storage	0	250	0
Men's Restroom	2	1,000	2,000
Women's Restroom	2	1,000	2,000
Family/Unisex	1	60	60
CEP - Chillers	1	1,200	1,200
CEP - Water Treatment	1	300	300
CEP - Main Electrical & Switchgear	0	1,125	0
CEP - Pumps	1	1,215	1,215
Mech Mezzanine / Air Handlers	1	3,200	3,200
CORE FUNCTIONS & SUPPORT Subtotal			25,500

OUTDOOR BUILDING SPACES

3 acres

4% of 67 acre site

	# SPACES	SF/SPACE	NET SF
Ramp	1	100,000	100,000
CEP - Cooling Towers	1	3,840	3,840
Generator Yard	1	300	300
Compressor Yard	1	300	300
Box/Compactor Area	1	300	300
Thermal Ice Storage Yard	0	2,400	0
Loading Area/Service	1	600	600
Service Yard	1	6,000	6,000
Trash Dumpster Area	1	300	300
Main/Student Entry Porch	1	6,000	6,000
Faculty/Guest Entry Porch	1	6,000	6,000
Outdoor Café Plaza	1	2,000	20,000
OUTDOOR BUILDING Subtotal			143,640

• See footnote 2

SITE ELEMENTS

67 acres

100% of site (tracts A and A-2)

EASEMENTS	# SPACES	SF/SPACE	NET ACREAGE
AT&T Distribution Easements	1		3
CPW Water Tunnel Easement	1		6
SCE&G Transmission Easements	1		7
WETLANDS			
Wetlands	1		17
Wetlands Buffer	1		5
DEVELOPABLE HIGHLANDS ELEMENTS			
Building (assumes entire footprint on First Floor)			3
Outdoor Building (includes Ramp)			3
Visitor Parking	100	425	1
Student Parking	450	425	8
Employee Parking	100	425	1
Carpool/Van/Alt Fuel Parking	8	425	1
Ramp / Secured Parking	2	425	1
Stormwater Detention			3
Highlands Acres Remaining			7

IV. PROGRAMMING

& Allocation of Spaces and Uses

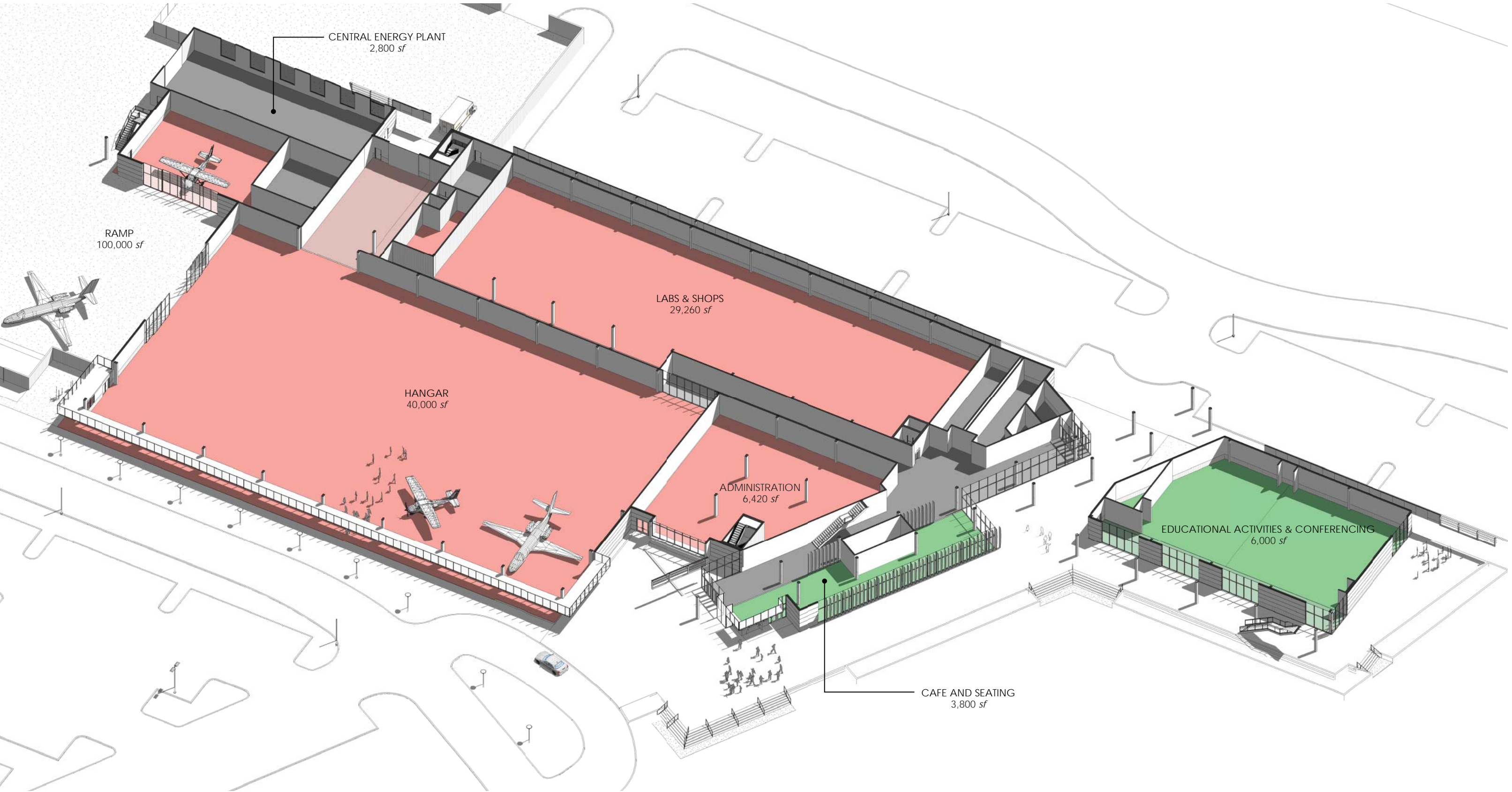

CENTRAL ENERGY PLANT
2,800 sf

RAMP
100,000 sf

LABS & SHOPS
29,260 sf

HANGAR
40,000 sf

ADMINISTRATION
6,420 sf

EDUCATIONAL ACTIVITIES & CONFERENCING
6,000 sf

CAFE AND SEATING
3,800 sf

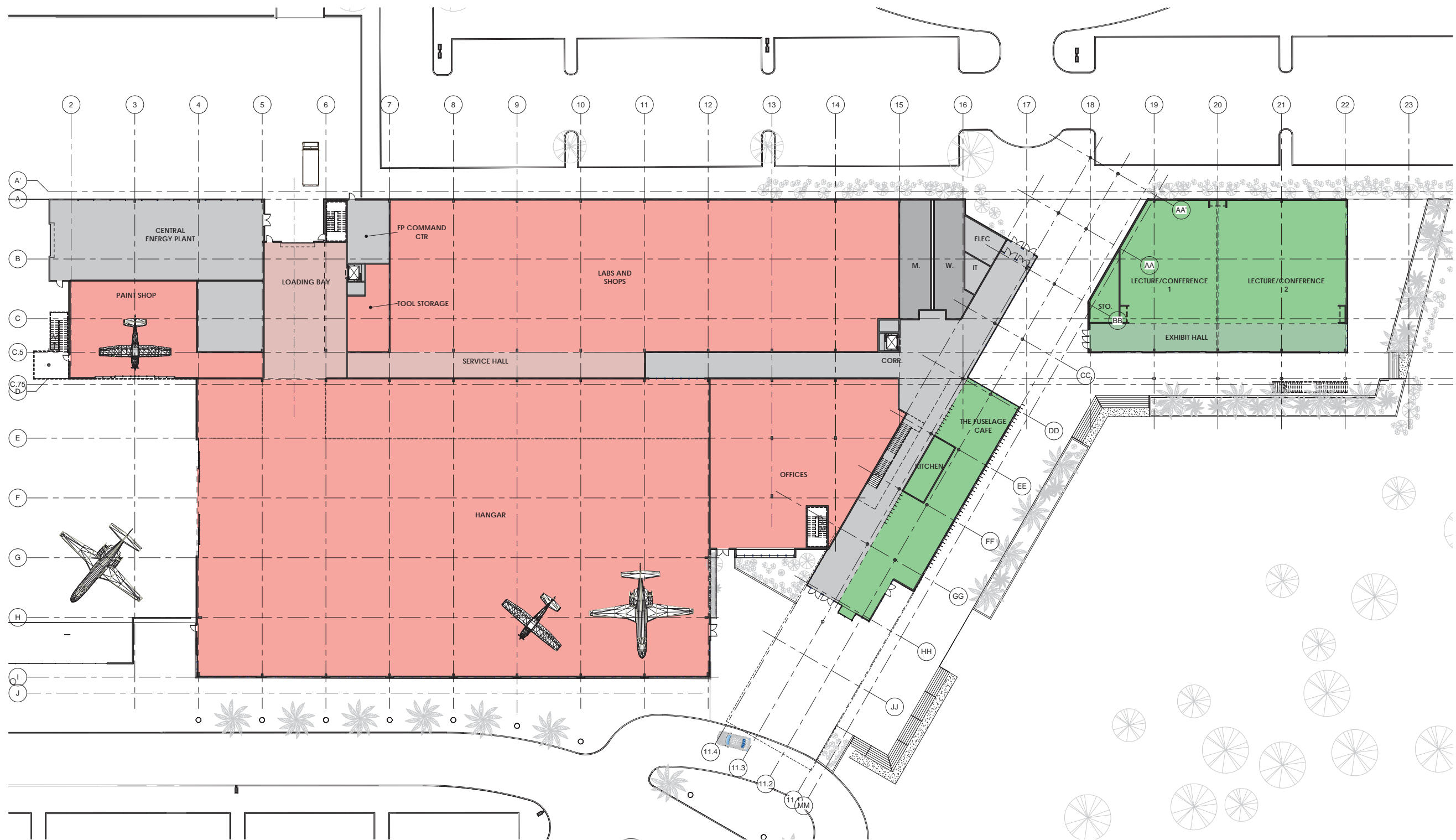

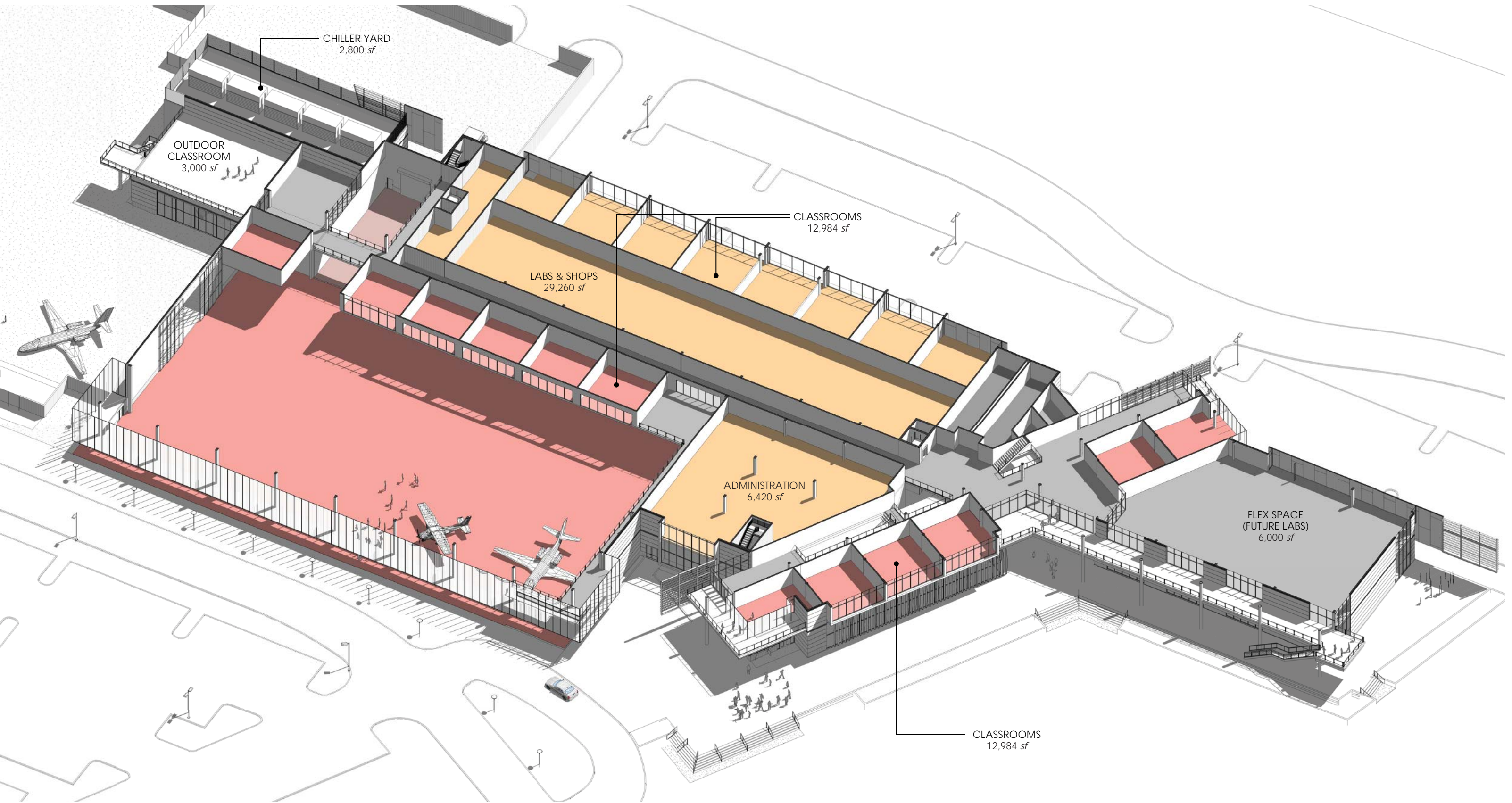

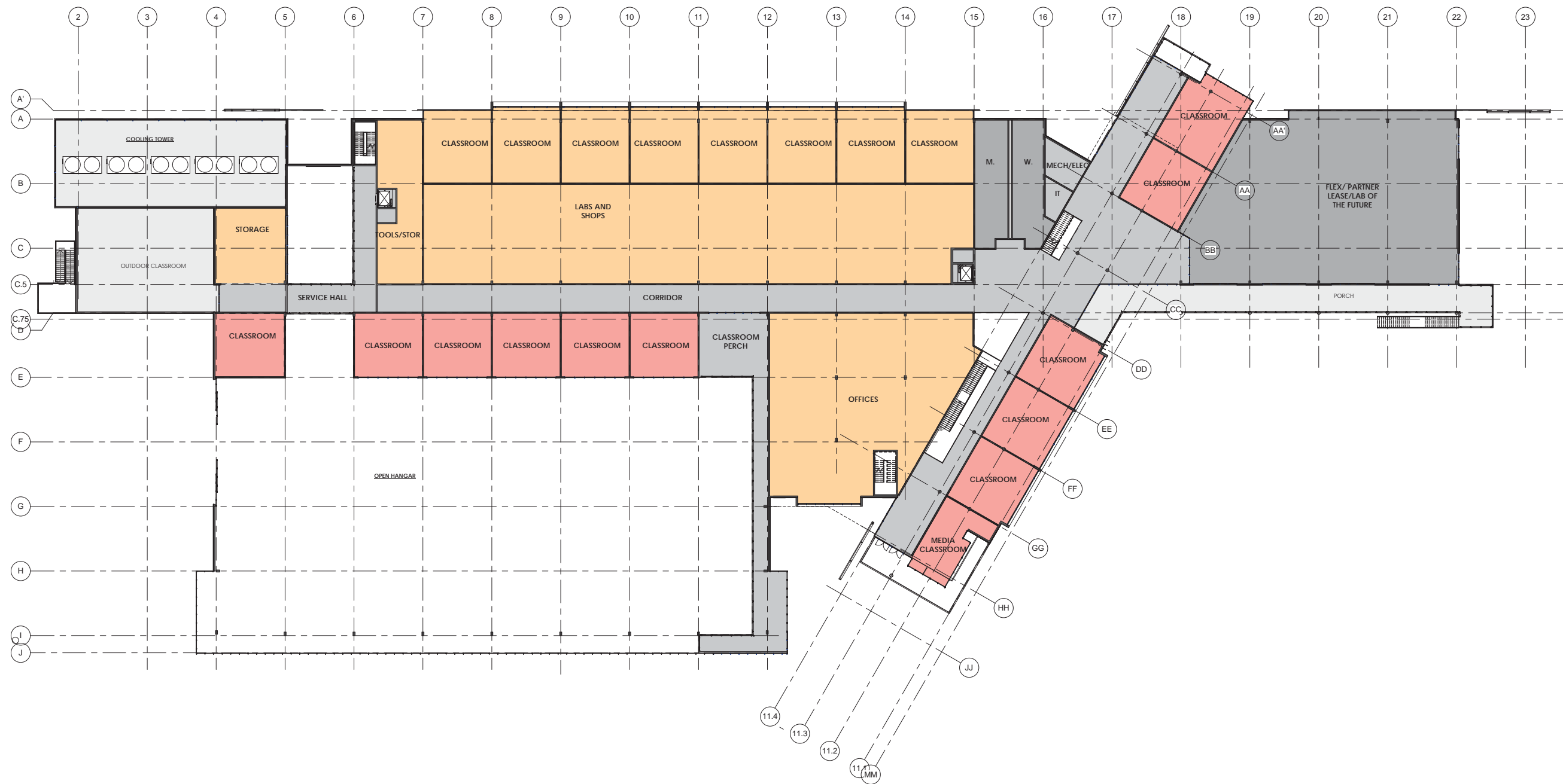

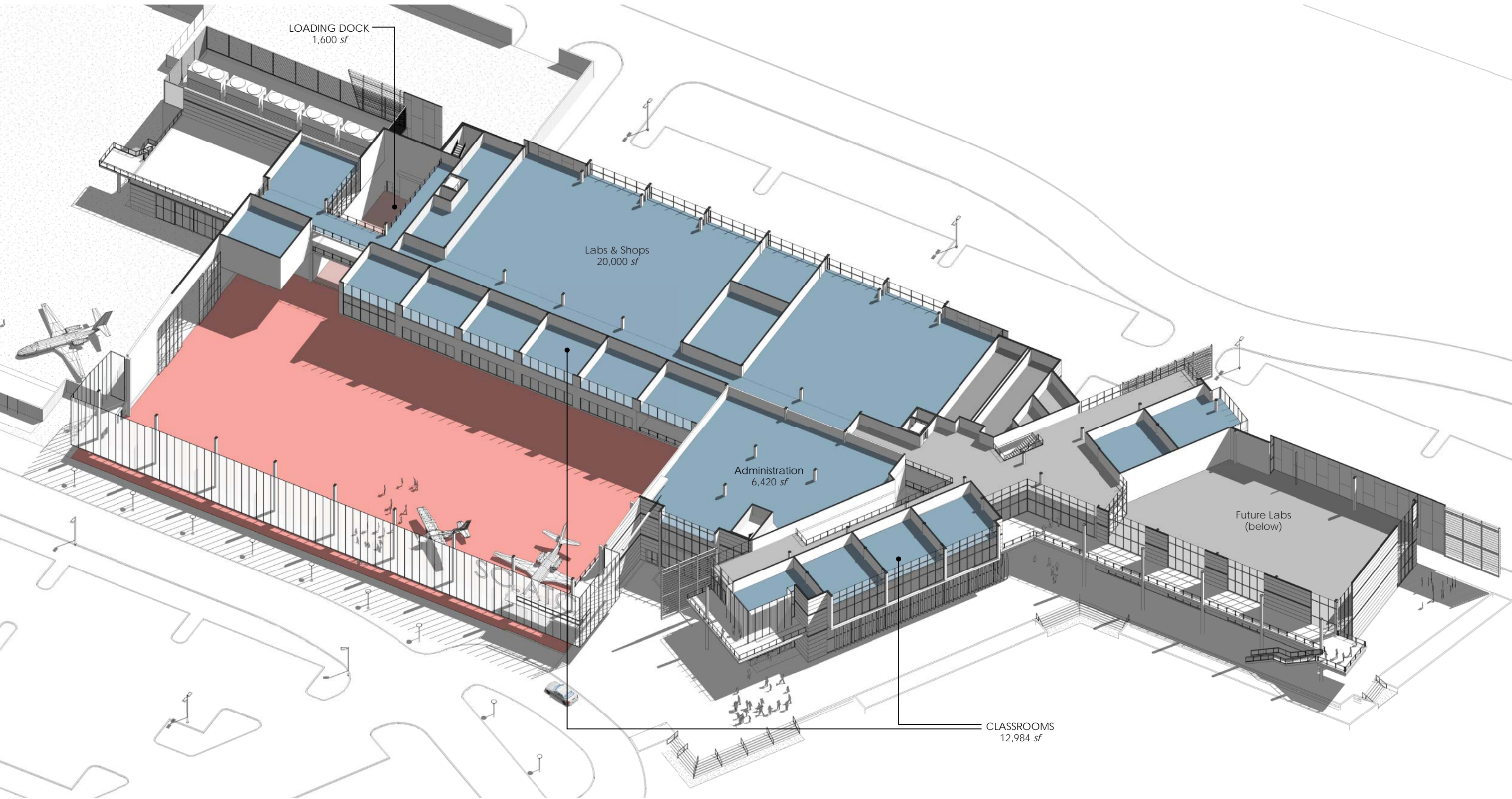

LOADING DOCK
1,600 sf

Labs & Shops
20,000 sf

Administration
6,420 sf

CLASSROOMS
12,984 sf

Future Labs
(below)

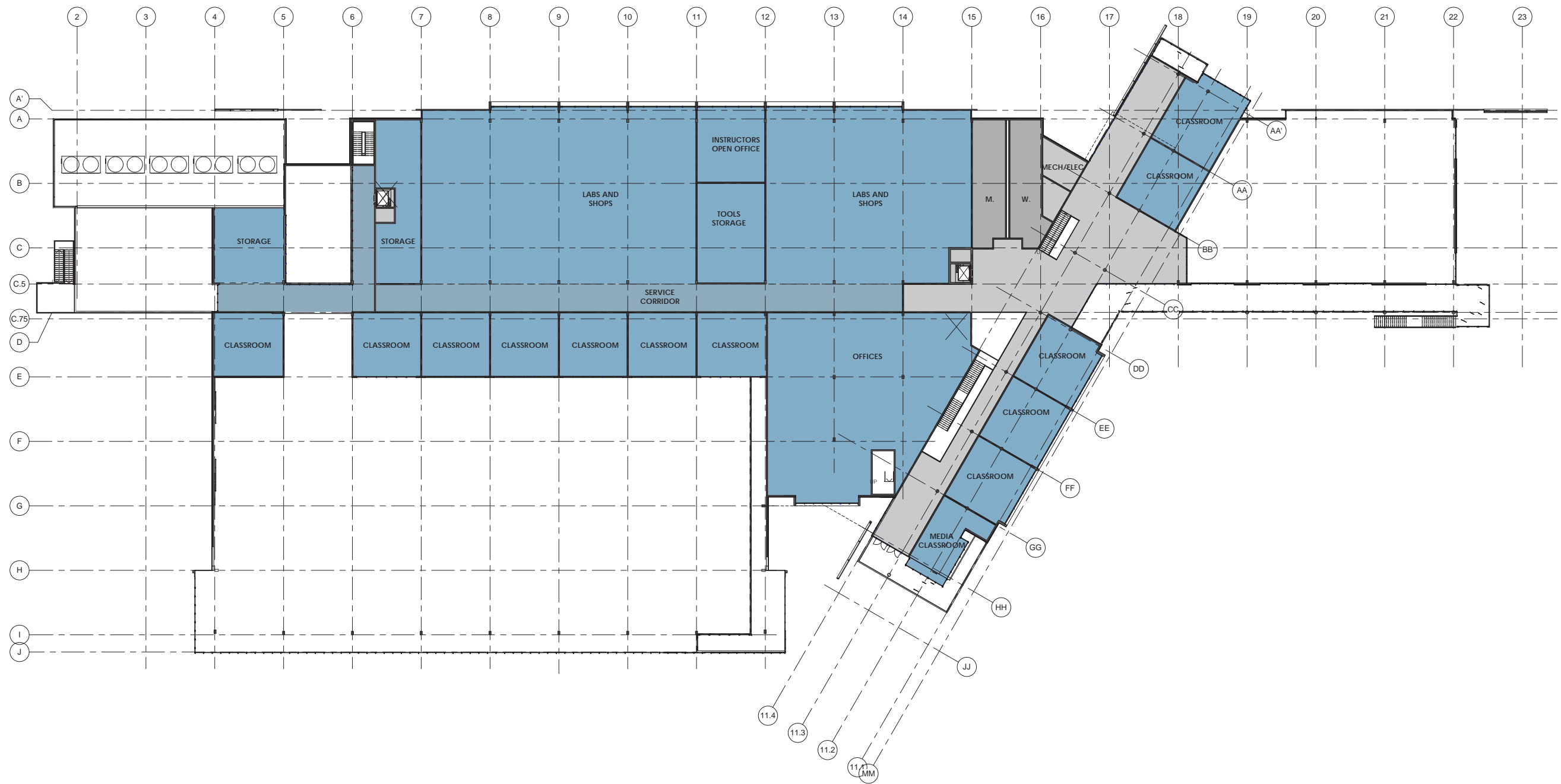



mechanical

biological

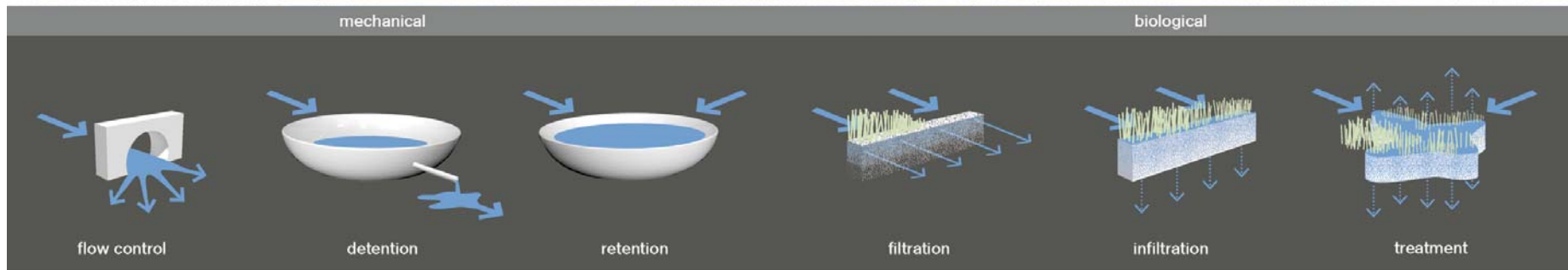

flow control

detention

retention

filtration

infiltration

treatment

Low Impact Development: A Design Manual for Urban Areas

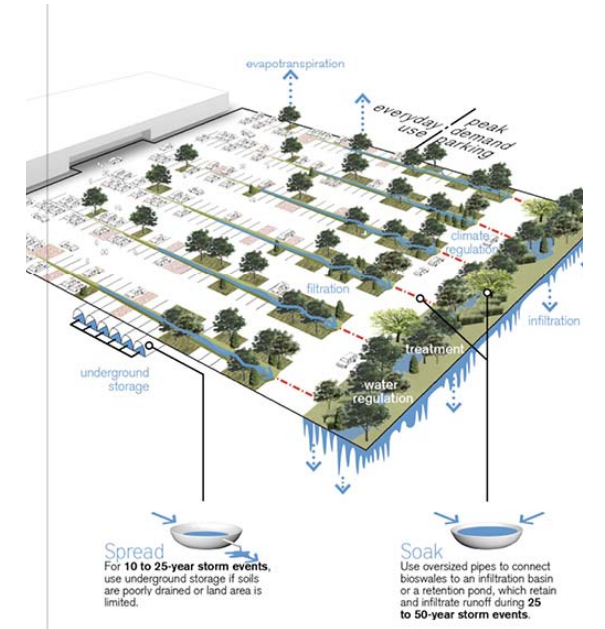
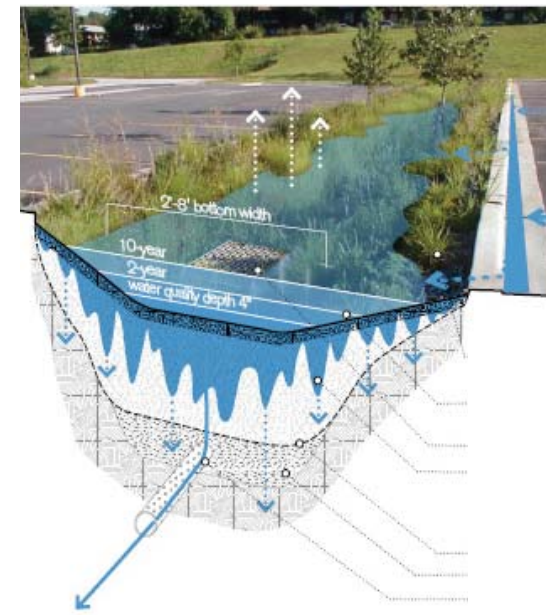

www.archdaily.com



www.wagnerhodgson.com



www.streetfilms.org



www.venturawatershed.com



www.bani.md



www.sctv.org



www.pinterest.com



www.magicblueproperty.com



LEED v4 for BD+C: New Construction and Major Renovation
SUMMARY OF POTENTIAL LEED CREDITS

Project Name: **South Carolina Aeronautical Training Center**
Date: **May 2015 - Concept Design**
Target: **SILVER**

Y ? N

1			Integrative Process	1
---	--	--	---------------------	---

2	3	11	Location and Transportation	16
---	---	----	------------------------------------	-----------

			LEED for Neighborhood Development Location	16
1			Sensitive Land Protection	1
	2		High Priority Site	2
	5		Surrounding Density and Diverse Uses	5
1	4		Access to Quality Transit	5
1			Bicycle Facilities	1
1			Reduced Parking Footprint	1
	1		Green Vehicles	1

2	5	3	Sustainable Sites	10
---	---	---	--------------------------	-----------

Y			Construction Activity Pollution Prevention	Required
1			Site Assessment	1
	2		Site Development - Protect or Restore Habitat	2
	1		Open Space	1
2	1		Rainwater Management	3
2			Heat Island Reduction	2
1			Light Pollution Reduction	1

9	2	0	Water Efficiency	11
---	---	---	-------------------------	-----------

2			Outdoor Water Use Reduction	2
6			Indoor Water Use Reduction	6
	2		Cooling Tower Water Use	2
1			Water Metering	1

16	8	9	Energy and Atmosphere	33
----	---	---	------------------------------	-----------

4	2		Enhanced Commissioning	6
11	2	5	Optimize Energy Performance	18
1			Advanced Energy Metering	1
	2		Demand Response	2
	1	2	Renewable Energy Production	3
	1		Enhanced Refrigerant Management	1
		2	Green Power and Carbon Offsets	2

Tracking Credits during Site Design to Maximize Credits

5	6	2	Materials and Resources	13
---	---	---	--------------------------------	-----------

Y			Storage and Collection of Recyclables	Required
Y			Construction and Demolition Waste Management Planning	Required
	3	2	Building Life-Cycle Impact Reduction	5
1	1		Building Product Disclosure and Opt - Environmental Product	2
1	1		Building Product Disclosure and Opt - Sourcing of Raw Materials	2
1	1		Building Product Disclosure and Opt - Material Ingredients	2
2			Construction and Demolition Waste Management	2

8	2	6	Indoor Environmental Quality	16
---	---	---	-------------------------------------	-----------

Y			Minimum Indoor Air Quality Performance	Required
Y			Environmental Tobacco Smoke Control	Required
	1	1	Enhanced Indoor Air Quality Strategies	2
3			Low-Emitting Materials	3
1			Construction Indoor Air Quality Management Plan	1
2			Indoor Air Quality Assessment	2
	1		Thermal Comfort	1
2			Interior Lighting	2
		3	Daylight	3
		1	Quality Views	1
		1	Acoustic Performance	1

6	0	0	Innovation	6
---	---	---	-------------------	----------

5			Innovation	5
1			LEED Accredited Professional	1

2	2	0	Regional Priority	4
---	---	---	--------------------------	----------

1			Regional Priority: Specific Credit	1
1			Regional Priority: Specific Credit	1
	1		Regional Priority: Specific Credit	1
	1		Regional Priority: Specific Credit	1

21 28 31 TOTALS Tracking for: **SILVER** Possible Points: 110
Certified: 40 to 49 points, **Silver: 50 to 59 points**, Gold: 60 to 79 points, Platinum: 80 to 110

VI. LEED CHECKLIST
& Low Impact Development Case Studies

